

VENTURA

BLVD.

ST.

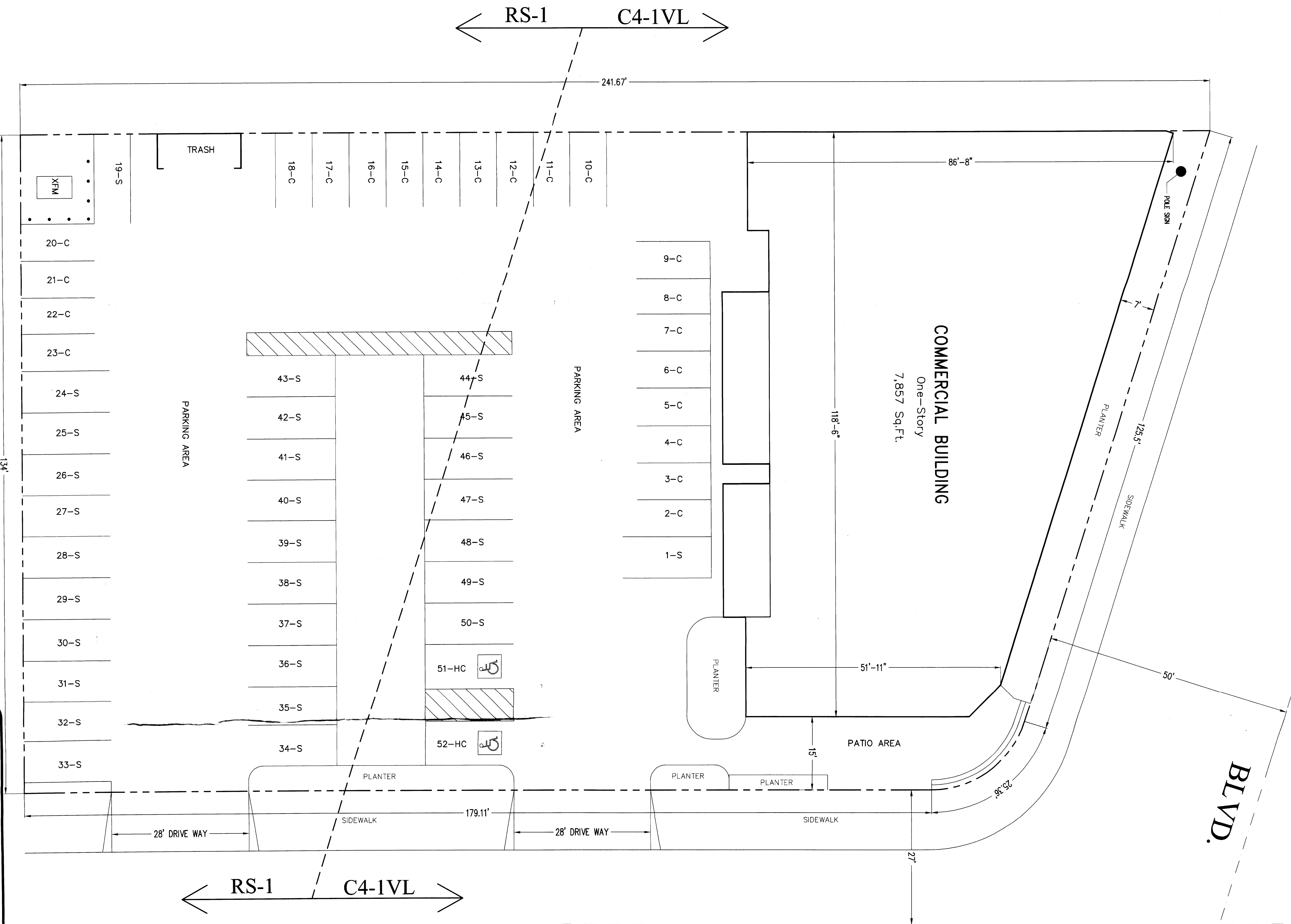

Site Description

Total Site Area = 29,538 Sq.Ft.
Total Floor Area = 7,857 Sq.Ft.

Legal Description

Por. Lot 4, Block 1, Tract No. 2955, M.B. 31-62/70 and Lot 1, Tract No. 19321, M.B. 481-1/2

Parking Required

Existing Supermarket, 7,857 Sq.Ft. (1 Space per 250 Sq.Ft.) = 32 Spaces
Total Parking Required = 32 Spaces

Parking Provided

Compact Spaces (7'-6" X 15' 1/2") = 21 Spaces
Standard Spaces (8'-4" X 18' 1/2") = 29 Spaces
Handicapped Spaces (14' X 18' 1/2") = 2 Spaces
Total Parking Provided = 52 Spaces

EXHIBIT "A"
Page No. 1 of 2
Case No. ZA-2015-2284-02B

PLOT PLAN

SCALE: 1" = 10'

CONTINENTAL MAPPING SERVICE



6315 VAN NUYS BLVD. # 208
VAN NUYS, CA 91401
818-787-1663

SITUS: SUPER SAL MARKET
17630 W. VENTURA BLVD.
ENCINO, CA 91316

CASE No: ZA 2015-2284
DATE: 5-12-14

CMS 11-6094

D.M. : 171 B 129

