

ENCINO *Village* Coming Soon

Grocery / Restaurant / Retail / Beauty / Boutique Fitness / Medical



16650 VENTURA BOULEVARD | ENCINO, CALIFORNIA



PEGASUS

NAICapital
COMMERCIAL REAL ESTATE SERVICES, WORLDWIDE

(424) 363-7800

Highlights



- Freestanding Corner Anchor Space
± 12,500 SF (Divisible)
- ± 11,000 SF of Country Mart Style Shop Space to Follow
- Located on 2+ AC at the Prominent Signalized Corner of Ventura Blvd. & Petit Ave.
- Walking Distance to Over 4.8 Million SF of High-Rise Office & Medical Buildings with a Daytime Population of Nearly 100,000+ People within 3 Miles
- Excellent Access & Visibility with Multiple Points of Ingress & Egress
- Irreplaceable & Massive Pylon Signage Opportunities
- At Grade Parking Ratio in Excess of ± 6 : 1000 SF with Nearly ± 150 Spots
- AHHI Nearly \$200,000 within 1 Mile

As Built



Proposed New Elevations



PROPOSED SITE PLAN | ENCINO VILLAGE

UNIT	SIZE	
A	± 7,018 SF	± 12,500 SF
B	± 5,321 SF	
C	± 1,561 SF	± 5,500 SF
D	± 1,443 SF	
E	± 1,336 SF	
F	± 1,138 SF	± 5,000 SF
G	± 1,213 SF	
H	± 1,342 SF	
I	± 1,211 SF	
J	± 1,013 SF	

CAN BE COMBINED

± 50,000 VPD

VENTURA BLVD

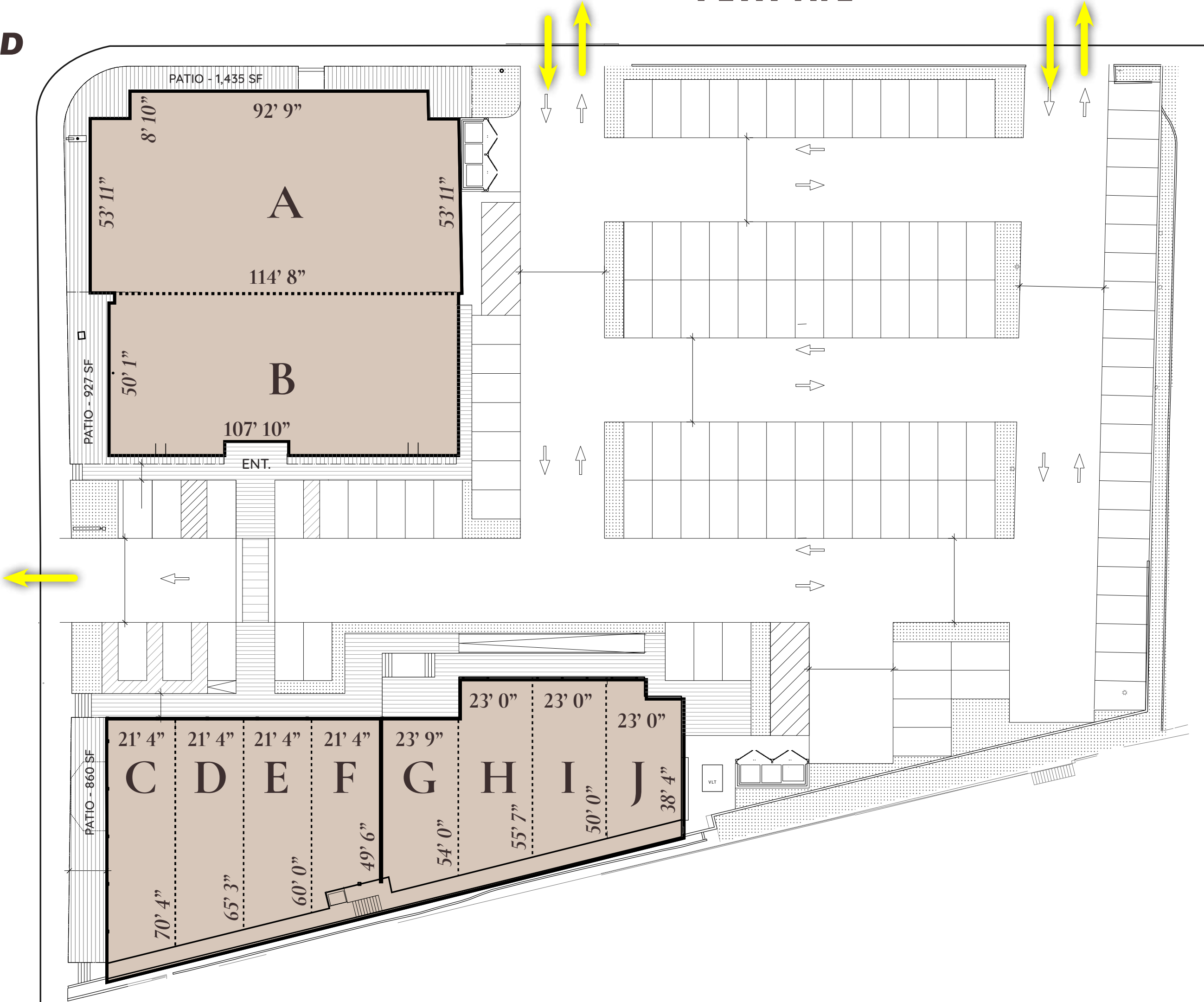

ENCINO PLACE



Scratch | Bar & Kitchen

Encino Hospital Medical Center



ENCINO MARKETPLACE



VENTURA BLVD

PETIT AVE

+ 50,000 VPD

PROPERTY DEMOGRAPHICS	1-MILE	2-MILE	3-MILE
2023 POPULATION	10,590	49,508	141,833
AVG. HOUSEHOLD INCOME	\$167,657	\$133,205	\$116,435
DAYTIME EMPLOYMENT POPULATION	22,193	42,765	87,231

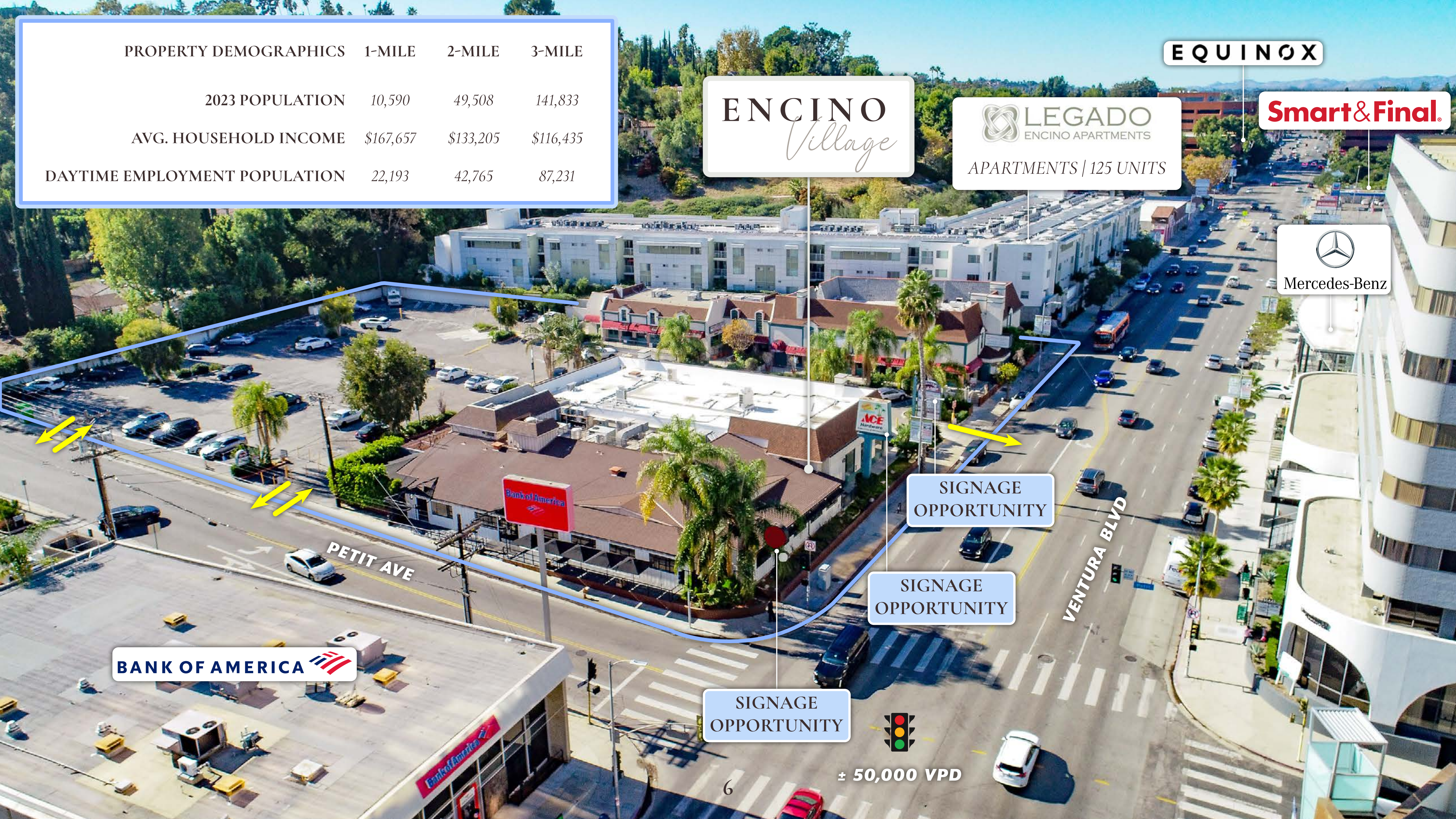

ENCINO
Village

LEGADO
ENCINO APARTMENTS
APARTMENTS / 125 UNITS

EQUINOX

Smart & Final

Mercedes-Benz

SIGNAGE
OPPORTUNITY

SIGNAGE
OPPORTUNITY

SIGNAGE
OPPORTUNITY

BANK OF AMERICA

VENTURA BLVD

PETIT AVE



± 50,000 VPD

ENCINO *Village*

16650 VENTURA BOULEVARD | ENCINO, CALIFORNIA



PEGASUS ASSET MANAGEMENT INC.

1901 Avenue of the Stars, Suite 630
Los Angeles, CA 90067
CA DRE LIC # 02119442
www.pegasusam.com



NAI CAPITAL COMMERCIAL, INC.

15821 Ventura Boulevard, Suite 320
Encino, CA 91436
CA DRE LIC # 02130474
www.naicapital.com

The information contained in this Leasing Package is proprietary and strictly confidential. It is intended to be reviewed only by the party receiving it from Pegasus Asset Management and should not be made available to any other person or entity without the written consent of Pegasus Asset Management. This Leasing Package has been prepared to provide summary, unverified information to prospective purchasers, and to establish only a preliminary level of interest in the subject property.

The information contained herein is not a substitute for a thorough due diligence investigation. Pegasus Asset Management has not made any investigation, and makes no warranty or representation, with respect to the income or expenses for the subject property, the future projected financial performance of the property, the size and square footage of the property and improvements, the presence or absence of contaminating substances, PCB's or asbestos, the compliance with State and Federal regulations, the physical condition of the improvements thereon, or the financial condition of the business prospects of any tenants, or any tenant's plans or intentions to continue its occupancy of the subject property.

The information contained in this Leasing Package has been obtained from sources we believe to be reliable; however, Pegasus Asset Management has not verified, and will not verify, any of the information contained herein, nor has Pegasus Asset Management conducted any investigation regarding these matters and makes no warranty or representation whatsoever regarding the accuracy or completeness of the information provided. Some or all of the photographs contained within may have been altered from their original format. All potential buyers must take appropriate measures to verify all of the information set forth herein.

LEASING TEAM

Andrew Cohen

EXECUTIVE VICE PRESIDENT | LEASING

acohen@pegasusam.com
(424) 363-7800
LIC # 01996379 (CA)

Emmet Pierson

SENIOR ASSOCIATE | LEASING

epierson@pegasusam.com
(424) 363-7800
LIC # 02048600 (CA)

Steven Weiss

EXECUTIVE VICE PRESIDENT

sweiss@naicapital.com
(818) 905-2400
LIC # 00680554 (CA)